

Steel Adaptors and Idler Sprockets

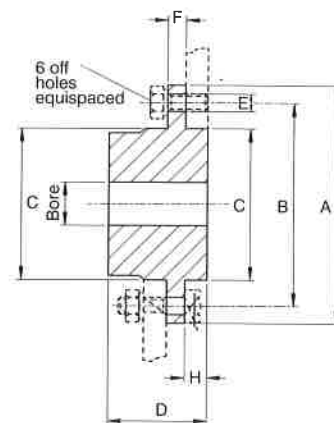

Detachable Hubs

Hub Ref.	Min. Bore	Max. Bore	A	B	C	D	E	F	H	App. Wt.
D30	8	20	55	45	30	20.0	4.2	4	3.0	0.15
D40	10	26	70	58	40	25.0	5.2	5	5.2	0.32
D50	14	32	80	67	50	32.0	6.2	7	7.0	0.61
D60	16	40	90	76	60	38.5	6.2	7	8.7	0.95
D70	20	45	110	94	70	45.5	8.2	8	10.5	1.90
D80	25	52	130	107	80	55.0	8.2	12	15.0	2.65
D100	30	65	170	140	100	73.0	10.2	17	23.0	6.00
D140	35	90	220	182	140	83.0	12.2	20	23.0	13.08
D160	40	104	245	205	160	93.0	16.5	25	25.0	18.80



All dimensions in mm.
Hubs can be supplied bored and keyed to customers requirements.

Idler Sprockets

The standard Idler Sprockets in this series are supplied complete with built in fully shielded and greased for life ball bearing, providing full lifetime maintenance free operation. Two standards of bearings are offered, an economy bearing for light duty applications, and a top quality European bearing for higher loads and speeds.

The extended width inner race enables correct mounting on the shaft without the need for spacers. The sprocket is manufactured from medium carbon steel and secured to the outer race of the bearing by press fit. Many chain drives, by virtue of their design, require a tensioning sprocket, and where fixed idlers are preferred this range of Idler Sprockets provides the ideal solution.

In addition to the standard range, Idler Sprockets can be manufactured to order to suit other sizes of B.S. Standard Chains and ANSI Series, in both Simplex and Multistrand construction, and with alternate numbers of teeth.



Part No.	Chain Size	Sprocket Dimensions				Bearing Dimensions				Weight Approx. kg
		No. Teeth	P.C.D.	OD	Tooth Width	Min Bore	Hub Dia	LTB		
		Z	dp	do	A	d	F	B	H	
IS05B1-23T	05B1	23	58.75	62.0	7.0	16.0	40.0	12.0	18.3	0.15
IS06B1-20T	06B1	20	60.89	64.3	7.0	16.0	40.0	12.0	18.3	0.07
IS06B1-21T	06B1	21	63.90	68.0	7.0	16.0	40.0	12.0	18.3	0.16
IS081-18T	081	18	73.14	78.9	7.0	16.0	40.0	12.0	18.3	0.21
IS083-16T	083	16	65.10	70.9	7.0	16.0	40.0	12.0	18.3	0.50
IS083-18T	083	18	73.14	78.9	7.0	16.0	40.0	12.0	18.3	0.20
IS08B1-14T	08B1	14	57.07	61.8	7.2	16.0	40.0	12.0	18.3	0.11
IS08B1-15T	08B1	15	61.09	65.5	7.2	16.0	40.0	12.0	18.3	0.12
IS08B1-16T	08B1	16	65.10	69.5	7.2	16.0	40.0	12.0	18.3	0.18
IS08B1-18T	08B1	18	73.14	77.8	7.2	16.0	40.0	12.0	18.3	0.23
IS08B1-20T	08B1	20	81.19	85.8	7.2	16.0	40.0	12.0	18.3	0.26
IS08B1-21T	08B1	21	85.22	89.7	7.2	16.0	40.0	12.0	18.3	0.26
IS10B1-13T	10B1*	13	66.32	73.0	9.1	16.0	40.0	12.0	18.3	0.24
IS10B1-14T	10B1*	14	71.34	78.0	9.1	16.0	40.0	12.0	18.3	0.24
IS10B1-15T	10B1*	15	76.36	83.0	9.1	16.0	40.0	12.0	18.3	0.27
IS10B1-16T	10B1*	16	81.37	88.0	9.1	16.0	40.0	12.0	18.3	0.32
IS10B1-17T	10B1*	17	86.39	93.0	9.1	16.0	40.0	12.0	18.3	0.33
IS10B1-18T	10B1*	18	91.42	98.3	9.1	16.0	40.0	12.0	18.3	0.30
IS10B1-21T	10B1*	21	106.52	113.4	9.1	16.0	40.0	12.0	18.3	0.50
IS12B1-12T	12B1	12	73.60	81.5	11.1	16.0	40.0	12.0	18.3	0.32
IS12B1-13T	12B1	13	79.59	87.5	11.1	16.0	40.0	12.0	18.3	0.36
IS12B1-15T	12B1	15	91.63	99.8	11.1	16.0	40.0	12.0	18.3	0.45
IS12B1-16T	12B1	16	97.65	105.5	11.1	16.0	40.0	12.0	18.3	0.50
IS16B1-12T	16B1	12	98.14	109.0	16.2	20.0	47.0	14.0	17.7	0.65
IS16B1-15T	16B1	15	122.17	133.0	16.2	20.0	47.0	14.0	17.7	1.10
IS16B1-17T	16B1	17	138.24	149.0	16.2	20.0	47.0	14.0	17.7	1.50
IS20B1-13T	20B1	13	132.65	147.8	18.5	25.0	52.0	15.0	21.0	1.50

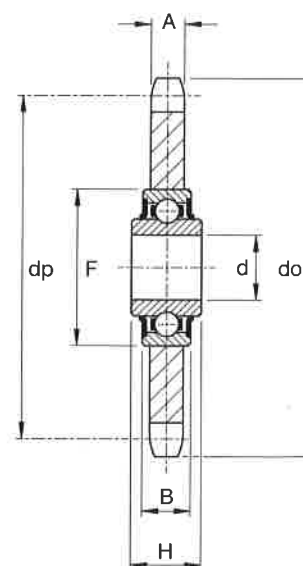

*Also suitable for ANSI 50 Chain.